

PLAN DE AMPLASAMENT SI DELIMITARE AL IMOBILULUI
Scara 1:500

ANEXA NR.1.35
la regulamentul

Nr.cadastral	Suprafata măsurată a imobilului (mp)	Adresa imobilului
250588	8420	Str. Ariei, Nr.12
Nr.Carte Funciară		Unitate Administrativ Teritorială (UAT)
250588		Mun. Bucuresti, Sector 1

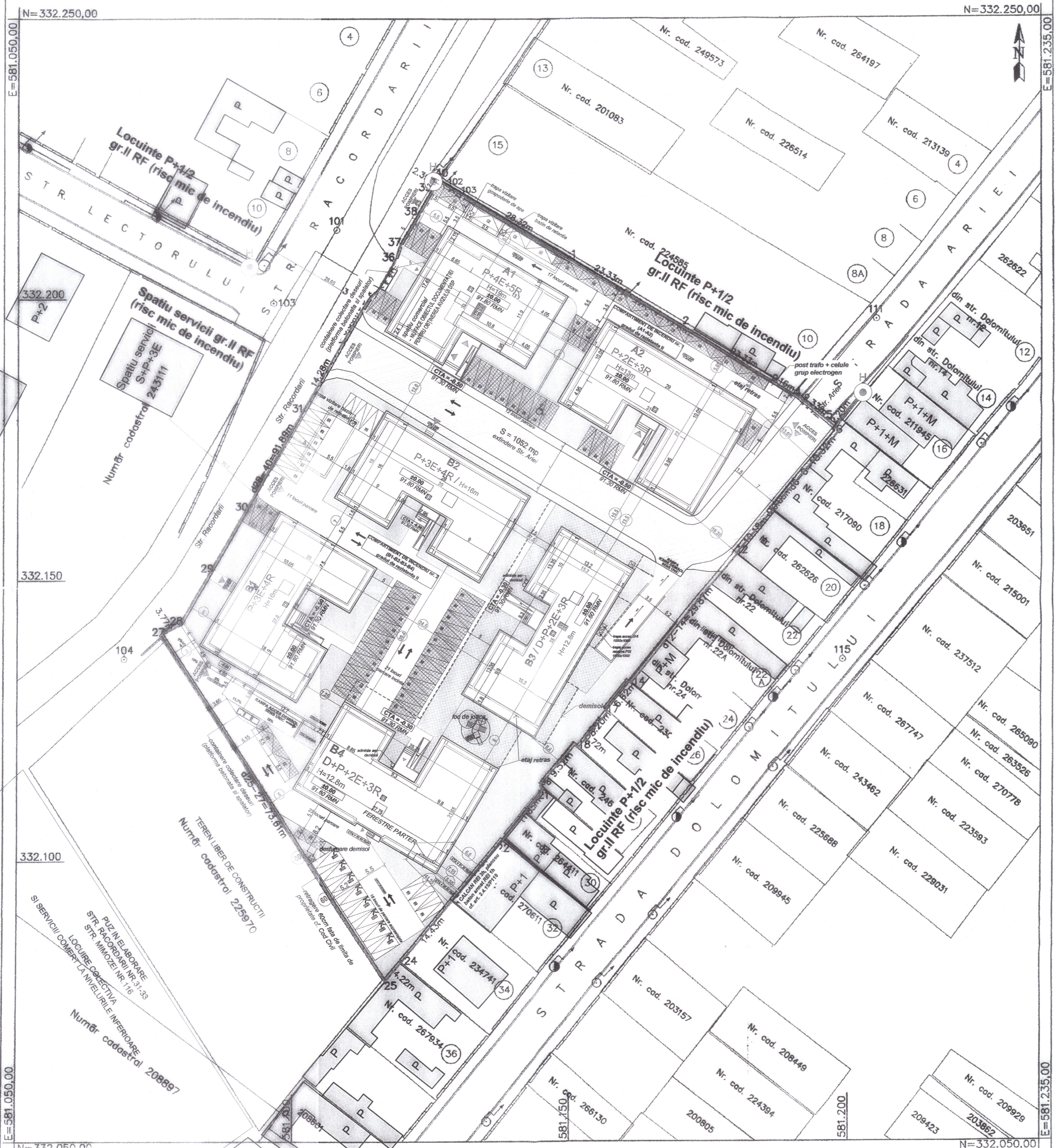

- LEGENDA**
- LIMITA TEREN
 - AMPRENTA CLADIRI
 - LIMITA DEMISOL COMUN B3-B4
 - ETAJ RETRAS
 - ▲ ACCESE
 - SPATIU VERDE PE PAMANT NATURAL
 - SPATIU VERDE PE PAMANT NATURAL (DALE INIERBATE)
 - SPATIU VERDE PE PLACA (PESTE DEMISOL)
 - SPATIU CIOMERCIAL (PARTER CORP A1)

INDICATORI URBANISTICI

POT max. cf. PUZ = 45%
CUT max. cf. PUZ = 1.56

S teren (acte)=8412mp
S teren (masuratori cadastrale)=8420mp

s. platforme/alei/circulatii =2900mp

amprenta construita aferenta calculului POT = 2989.9mp
POT propus = 35.5%

S.c.d. supraterrana TOTAL = 12,047.1mp

S.c.d. supraterrana zona A = 4,290mp

S.c.d. supraterrana zona B = 7,757.1mp

CUT propus = 1.43

S. c. demisol = 1561.5mp

S. c. bazin retentie si camera de pompe

S. c. bazin retentie (zona B, subteran) = 8

Regim de inaltime propus

zona A: P+2E+3Er/5Er

zona B: S+P+2E+3Er/4Er

CORP A1

Cota 0.00=+91.80

Amprenta = 458.9mp

P+4E+5Er (19m)

Nr. apartamente = 31ap.

S.c. comercial = 120mp*

Acid = 2394.5 mp

*SPATIUL COMERCIAL NU FACE OBIECTUL DOCUMENTAȚIEI PENTRU OBTINEREA

CORP B1

Cota 0.00=+91.80

Amprenta = 492.5mp

P+4E+4Er (16m)

Nr. apartamente = 28ap.

Acid = 2097.20 mp

TOTAL 148 apartamente

CORP B2

Cota 0.00=+91.80

Amprenta = 484.3mp

P+4E+4Er (16r)

Nr. apartamente = 28ap.

Acid = 2134.2 mp

CORP B3

Cota 0.00=+91.80

Amprenta = 484.7mp

P+4E+3Er (12.8m)

Nr. apartamente = 19ap.

Acid = 1844.10 mp

CORP B4

Cota 0.00=+91.80

Amprenta = 530.0mp

P+4E+3Er (12.8m)

Nr. apartamente = 19ap.

Acid = 1844.10 mp

TOTAL 169 locuri de parcare

pe sol natural = 2075.1 (24.7%)

*din care dale inierbate = 606.4mp

pe placa = 454.6mp (5.4%)

TOTAL = 2529.7mp (30%)

marilor locuri de parcare:

3 locuri de parcare supraterrane

3 locuri de parcare subterane

TOTAL: 169 locuri de parcare

10 supra + 86 infra = 102 locuri de parcare in sistem multietajat (tip Klaus)

CORP A1, A2, B1, B2

Cota +/- 0,00=+91,80

CTA - 0,50=+91,30

CORP B3 - B4

Cota +/- 0,00=+91,60

CTA - 0,30=+91,30

CATEGORIA DE IMPORTANȚĂ C- NORMALĂ (HGR 766/1997)

CLASA DE IMPORTANȚĂ III (P190-1/2013)

GRAD DE REZISTENȚĂ LA FOC II - NIVEL DE STABILITATE LA INCENDIU (P118/1999)

9/346/2017

9/346/2017

9/346/2017

9/346/2017

9/346/2017

9/346/2017

9/346/2017

9/346/2017

9/346/2017

9/346/2017

9/346/2017

9/346/2017

9/346/2017

9/346/2017

9/346/2017

9/346/2017

9/346/2017

9/346/2017

9/346/2017

9/346/2017

9/346/2017

9/346/2017

9/346/2017

9/346/2017

9/346/2017

9/346/2017

9/346/2017

9/346/2017

9/346/2017

9/346/2017

9/346/2017

9/346/2017

9/346/2017

9/346/2017

9/346/2017

9/346/2017

9/346/2017

9/346/2017

9/346/2017

9/346/2017

9/346/2017

9/346/2017

9/346/2017

9/346/2017

9/346/2017

9/346/2017

9/346/2017

9/346/2017

9/346/2017

9/346/2017

9/346/2017

9/346/2017

9/346/2017

9/346/2017

9/346/2017

9/346/2017

9/346/2017

9/346/2017

9/346/2017

9/346/2017

9/346/2017

9/346/2017

9/346/2017

9/346/2017

9/346/2017

9/346/2017

9/346/2017

9/346/2017

9/346/2017

9/346/2017

9/346/2017

9/346/2017

9/346/2017

9/346/2017

9/346/2017

9/346/2017

9/346/2017

9/346/2017

9/346/2017

9/346/2017

9/346/2017

9/346/2017

9/346/2017

9/346/2017

9/346/2017

9/346/2017

9/346/2017

9/346/2017

9/346/2017

9/346/2017

9/346/2017

9/346/2017

9/346/2017

9/346/2017

9/346/2017

9/346/2017

9/346/2017

9/346/2017

9/346/2017

9/346/2017

9/346/2017

9/346/2017

9/346/2017

9/346/2017

9/346/2017

9/346/2017

9/346/2017

9/346/2017

9/346/2017

9/346/2017

9/346/2017

9/346/2017

9/346/2017

9/346/2017

9/346/2017

9/346/2017

9/346/2017

9/346/2017

9/346/2017

9/346/2017

9/346/2017

9/346/2017

9/346/2017

9/346/2017

9/346/2017

9/346/2017

9/346/2017

9/346/2017

9/346/2017

9/346/2017

9/346/2017

9/346/2017

9/346/2017

9/346/2017

9/346/2017

9/346/2017

9/346/2017

9/346/2017

9/346/2017

9/346/2017

9/346/2017

9/346/2017

9/346/2017

9/346/2017

9/346/2017

9/346/2017

9/346/2017

9/346/2017

9/346/2017

9/346/2017

9/346/2017

9/346/2017

9/346/2017

9/346/2017

9/346/2017

9/346/2017

9/346/2017

9/346/2017

9/346/2017

9/346/2017

9/346/2017

9/346/2017

9/346/2017

9/346/2017

9/346/2017

9/346/2017

9/346/2017

9/346/2017

9/346/2017

9/346/2017

9/346/2017

9/346/2017

9/346/2017

9/346/2017

9/346/2017

9/346/2017

9/346/2017

9/346/2017

9/346/2017

9/346/2017

9/346/2017

9/346/2017

9/346/2017

9/346/2017

9/346/2017

9/346/2017

9/346/2017

9/346/2017

9/346/2017

9/346/2017

9/346/2017

9/346/2017

9/346/2017

9/346/2017